

Friction Stir Welding FSW

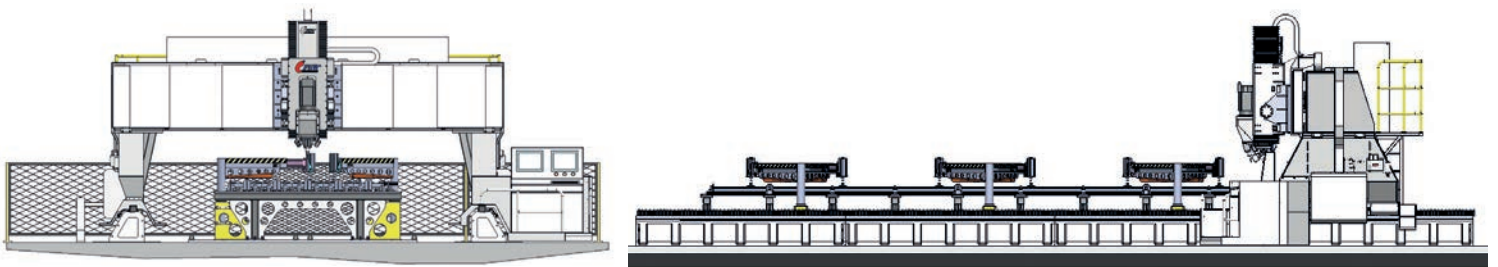

MOVING GANTRY MACHINE : Série LM-C



Specifications

Reference		From	To
Thickness (mm)	aluminum, cooper, steel	1	25
General Dimension (mm)	Length	16 000	60 000
	Width	10 000	10 000
	Height	3 900	
Working table (mm)	X	10 000	52 000
	Y	3 500	
Welding space (mm)	Z	1 400	
Working stroke (mm)	X axis	10 000	52 000
	Y axis	3 500	
	Z axis	500	
	B axis	±5°	
Working speed (mm/min)	X - Y axis	10 000	
	Z axis	1 500	
Rotation speed (rpm,max.)		1 500	2 500
Spindle power (KW,max.)		10	30
Vertical down force (KN)	Z axis	30	60

Information

- Numeric Controller (CNC) + Touch screen
- Position and force control
- Centralized and automatical lubrication

Options

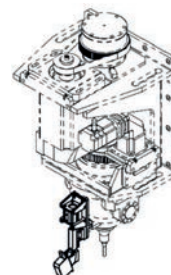

- Siemens Automation system (CNC)
- 2D Welding Y-X
- Lasertracking
- Workpiece cooling
- Retractable pin
- Spindle circular cooling
- Tools dynamic cooling
- Additionnal axis

Friction Stir Welding FSW



MOVING GANTRY MACHINE : Série LM-C



Parts examples

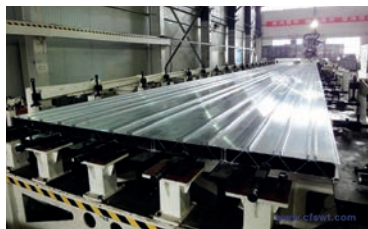
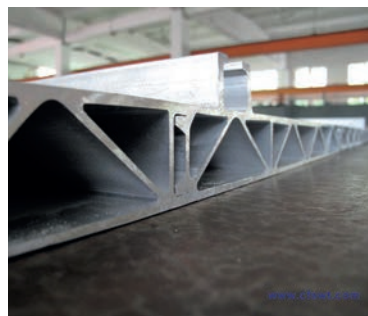
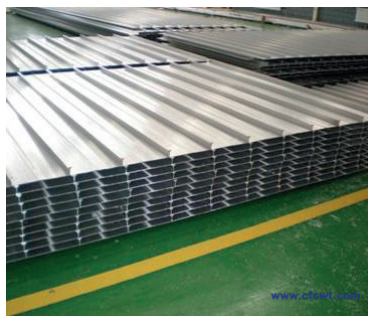

Applications

- Research and development (dissimilar material welding, ...)
- Automotive (battery tray, wheel, ...)
- Aircraft (fuselage, floor, ...)
- Railway (floor, body structure, ...)
- Aerospace (fuel tank, ...)
- Electronics (copper/aluminium connectic part, ...)
- Energy (Heat exchanger, ...)
- Shipbuilding (panel, floor, ...)
- University (R&D, ...)
- ...