

# Friction Stir Welding FSW

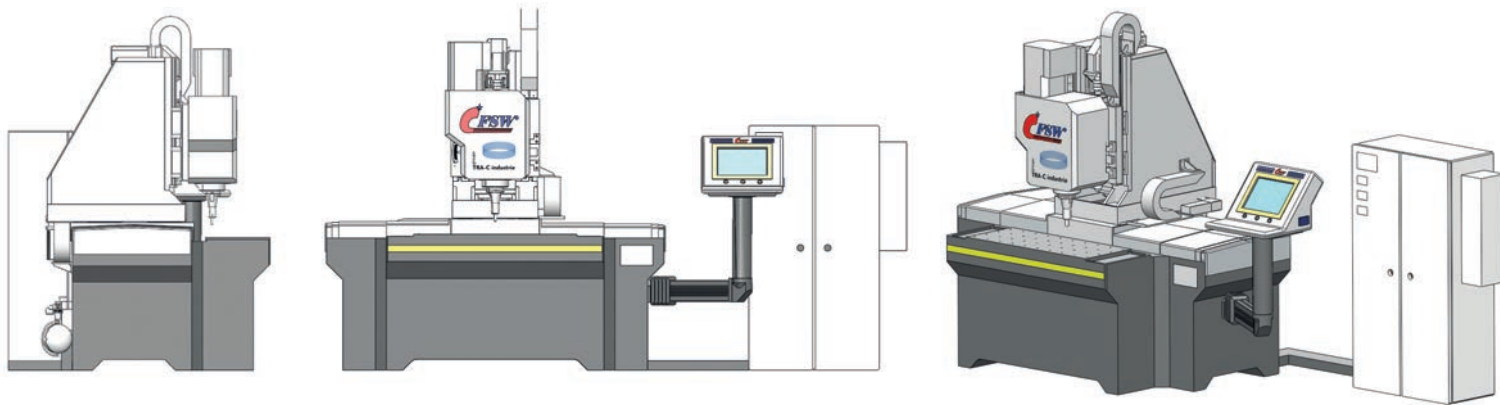

## TABLE MACHINE : Série TS



### Specifications

Reference		From	To
Thickness (mm)	aluminum, cooper, steel	1	16
General Dimension (mm)	Length	2 800	3 250
	Width	2 800	3 100
	Height	2 800	
Working table (mm)	X	1 100	1 150
	Y	700	950
Welding space (mm)	Z	400	450
Working stroke (mm)	X axis	1 000	1 350
	Y axis	600	850
	Z axis	300	
	B axis	±5°	
Working speed (mm/min)	X - Y axis	3 000	
	Z axis	1 500	
Rotation speed (rpm,max.)		1 500	2 000
Spindle power (KW,max.)		20	30
Vertical down force (KN)	Z axis	30	

### Information

- B&R Automation system (PLC) + Touch screen
- Position and force control
- Centralized and automatical lubrication

### Options

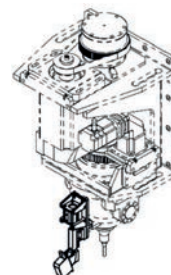

- Siemens Automation system (PLC)
- Workpiece cooling
- Retractable pin
- Spindle circular cooling
- Tools dynamic cooling
- Additionnal axis

# Friction Stir Welding FSW



## TABLE MACHINE : Série TS



### Parts examples



### Applications

- Research and development (dissimilar material welding, ...)
- Automotive (battery tray, wheel, ...)
- Aircraft (fuselage, floor, ...)
- Railway (floor, body structure, ...)
- Aerospace (fuel tank, ...)
- Electronics (copper/aluminium connectic part, ...)
- Energy (Heat exchanger, ...)
- Shipbuilding (panel, floor, ...)
- University (R&D, ...)
- ...